

Model: 3" ES

(26 Ga or 20 Ga Exterior)

I. GENERAL

A. Work Included

The doors will be Model 3" ES as manufactured by Midland Garage Door Mfg. Co.

B. Other Work

Related structure work, opening preparation, field painting and electrical work etc. falls into the responsibility of other trades.

II. PRODUCT

A. Sections

Sections will be roll-formed, hot dipped, galvanized G60 (minimum), a minimum yield strength of 33,000 psi, complying with ASTM A-653 and ASTM A924, 26 ga. pebble textured exterior and interior surface (optional 20 ga. exterior available). Sections will be pressure bonded to a closed cell polystyrene core and will have a thickness of 3". Sections will incorporate a PVC thermal break to prevent heat or cold conductivity.

B. Insulation

Insulation will be rigid 3" closed cell extruded polystyrene free of CFCs and HCFCs and will be laminated to provide strength and prevent loss of thermal efficiency over time. The insulation will have a calculated R-Value of 17.05 and U-Value of .062 complying with ASTM C236. Insulation material complying with ASTM E84 flame-spread and smoke-developed.

C. Air Infiltration

All doors will be constructed with a PVC strip and bulb seal between sections to resist air infiltration complying with ASTM E283 Maximum rate: 0.059 cfm@15mph and 0.091 cfm@25mph.

D. Windload

Doors will be designed to meet or exceed industry standards for windloads (ANSI/DASMA102-1996), uniform pressure (velocity pressure) of 20 lbf/sq. ft. acting inward and outward. Deflection of door in the horizontal position will not exceed 1/120 of the door width. Consult factory for unusual requirements.

E. End Stiles

End stiles will be 16 gauge (13 gauge optional) steel and incorporate a thermal break to help prevent heat/cold conductivity between the inside and outside steel skins.

F. Hardware

Hinges and fixtures will be G60 galvanized steel complying with ASTM A36 and ASTM A123. Full floating ball bearing rollers will have hardened steel races. Roller sizes will

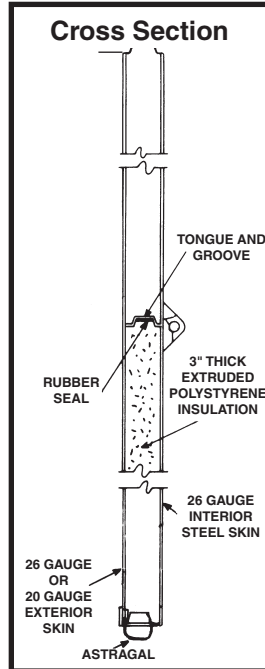

OPTIONAL GLASS: Thermal lites 24" x 7" or 24" x 12" are available. They are designed to provide maximum usability without sacrificing security.

Optional full vision sections are also available (shown above).

be adequate for design requirements and limitations.

G. Track

Track is 2" or 3" depending upon door size and requirements and angle mounted.

H. Spring Counterbalance

Counterbalance shall be oil tempered, helical wound torsion springs complying with ASTM A229, mounted on a ball bearing cross header shaft engineered to comply with ANSI/DASMA102-1996. Long life springs of 25,000, 50,000 or 100,000 cycles may be specified. Galvanized aircraft type lifting cables with minimum safety factor of 8 to 1 and cast aluminum drums are standard.

I. Lock

Lock will be interior mounted slide lock. (Optional commercial keyed lock is available.)

J. Weatherstrip

PVC Weatherstrip between sections meeting rubber tube seals fitted inside every joint. Bottom weatherstrip will be U'd shape astragal fastened to the bottom of the door with an extruded aluminum holder for an effective seal at the sill.

K. Finish

Finish will be baked-on polyester over epoxy primer. White interior and white or brown exterior. (20 Ga. exterior white only)

L. Operation

Operation will be by manual pull rope. Optional chain hoist and electric operator are available.

III. EXECUTION

Installation

Doors should be installed in compliance with Midland Garage Door Mfg. Co. instructions by authorized Midland Garage Door Installation Professionals.

OPTIONS

- Thermal Glazing
- High Cycle Springs
- Jamb Weatherstrip
- Electric Operator
- Chain Hoist
- Bottom Sensing Edge
- Rubber Header Seal
- Full Vision (White powder-coat) Aluminum Sections
- Harsh Environment

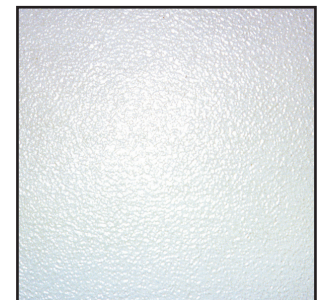

Pebble Texture Finish
Exterior and Interior